



## Three Bedroom Semi-Detached House

**Loggon Road, Basingstoke, Hampshire, RG21 3PF**

**Price: £390,000**

- Three Bedrooms
- Open Plan Lounge/Diner
- UPVC Double Glazing
- Good Schools Nearby
- Close to the Town Centre
- Potential to Extend STPP
- No Onward Chain Complications
- EPC: TBC



## Description

Located in the popular area of the Harrow Estate, this three bedroom home is available with no onward chain. With recently replaced fascia's and soffits and a modern boiler for gas central heating this home offers a lot of potential for the next owners. Sitting in a small enclave away from the main road, the property overlooks trees to the front, providing you with one of the best outlooks in Basingstoke.

A lot of the houses in this close and the surrounding roads have been extended over the years, which is testament to how good this area is to live in, whilst also providing existing precedents for those who are keen to design their own forever home.

The property has bay windows to the living room and main bedroom which bring in heaps of natural light and add to the character of the property, and the rear garden has been landscaped to provide two separate areas with a great deal of privacy and a small patio perfect for relaxing and enjoying the sun.

## Outside

The area of The Harrow Estate has always been popular with local people for the fact it is surrounded by areas of greenery and trees, and this property boasts one of the best locations within this area in our opinion. With easy access to local amenities and great schools, as well as giving easy access to the town centre, it really gives you the best of both worlds.

To view the Material Information Certificate for this property please click [Here](#) or contact us to request a copy.

## Floorplan

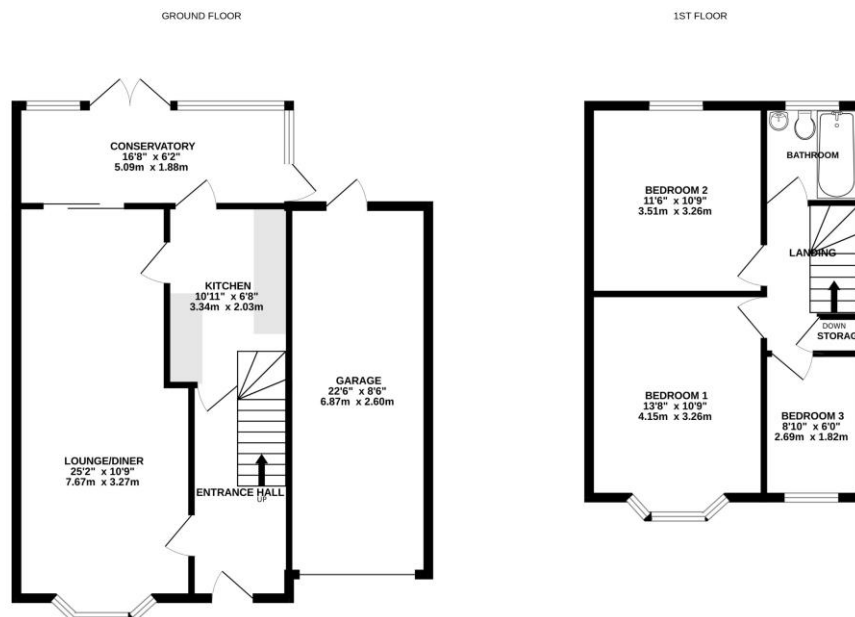

Whilst every attempt has been made to ensure the accuracy of the floorplan contained here, measurements of doors, windows, rooms and any other items are approximate and no responsibility is taken for any error, omission or mis-statement. This plan is for illustrative purposes only and should be used as such by any prospective purchaser. The services, systems and appliances shown have not been tested and no guarantee as to their operability or efficiency can be given.  
Made with Metropac C2025



TO ARRANGE A VIEWING PLEASE CONTACT:  
Tel: **01256 880001** or Email: **info@bridges.co.uk**



**Important Notice** - These particulars are set out as a general outline only for the guidance of intended purchasers/tenants and do not form part of any offer or contract and must not be relied upon as statements or representations of fact. Purchasers/Tenants must satisfy themselves by inspection or otherwise as to their correctness.