



## One Double Bedroom Apartment

**Compass House, 207-215 London Road, Surrey, GU15 3EY**

Guide Price: £200,000

- One Double Bedroom
- First Floor Executive Apartment
- High Specification
- Lift Access
- Camberley Town Centre
- Allocated Parking Space
- Estimated Rental Price: £1,100 pcm
- EPC: C (79)





## Description

A well presented one double bedroom first floor executive apartment located in the heart of Camberley town centre and offered to the market with one allocated parking space. The accommodation comprises a spacious entrance hall, open plan living room/fitted kitchen, bedroom and a bathroom. The property was recently constructed and refurbished to a high specification. An internal inspection is highly recommended to truly appreciate this apartment.

## Outside

The property also benefits from a communal secure bike store and one allocated parking space.

To view the Material Information Certificate for this property please click [Here](#) or contact us to request a copy.

## Floorplan

FIRST FLOOR

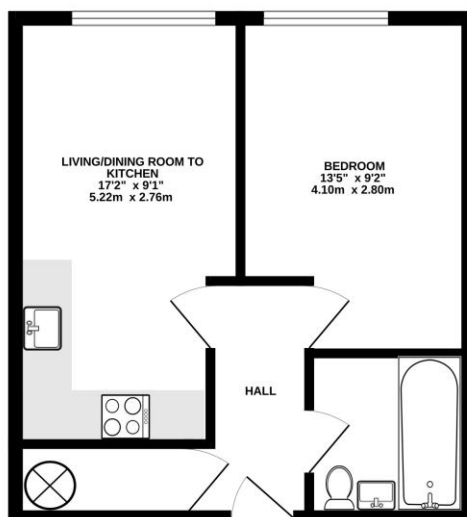

Whilst every attempt has been made to ensure the accuracy of the floorplan contained herein, measurements of floors, walls, rooms and any other parts are approximate and no responsibility is taken for any error, omission or misstatement. This plan is for illustrative purposes only and should be used as such by any prospective purchaser. The plan, layout and dimensions shown here are not intended and no guarantee as to their quantity or efficiency can be given.  
Made with Metaphor 11/2023



TO ARRANGE A VIEWING PLEASE CONTACT:

Tel: **01276 685544** or Email:  
**camberley@bridges.co.uk**



Important Notice - These particulars are set out as a general outline only for the guidance of intended purchasers/tenants and do not form part of any offer or contract and must not be relied upon as statements or representations of fact. Purchasers/Tenants must satisfy themselves by inspection or otherwise as to their correctness.