



## Three Bedroom Terraced House

**Jersey Close, Basingstoke, RG24 9PR**

Offers in Excess of: £300,000

- Three Bedrooms
- Brick Built Construction
- Walkway Location
- Downstairs Cloakroom
- Four Piece Bathroom with Shower Cubicle
- No Onward Chain
- 19'8 Foot Living/Dining Room
- EPC: C (69)





## Description

Offered to the market is this well presented three bedroom terraced home, ideally situated in a walkway within the sought after Islands development in Popley. The ground floor features a spacious 19'8 foot living/dining room, a separate kitchen, and a convenient downstairs cloakroom.

Upstairs, you'll find three generously sized bedrooms and a well appointed four piece family bathroom, which includes a separate shower cubicle. This property offers excellent space for families or first time buyers, with a practical layout and great potential for personalization.

## Outside

Outside, the front garden is mainly laid to lawn with a pathway leading to the front door, complemented by mature shrubs and a brick built storage shed for added convenience.

To the rear, the garden features a raised patio area enclosed by a brick wall, with steps leading down to a lawned garden. The space is fully enclosed with panel fencing and benefits from a rear access gate.

This property offers a great layout, both inside and out, and would make an ideal home for families, first time buyers, or investors.

## Floorplan

GROUND FLOOR

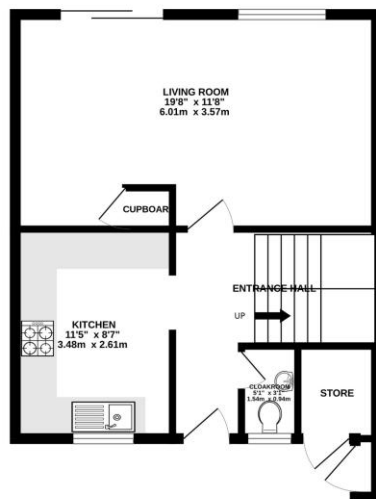

1ST FLOOR

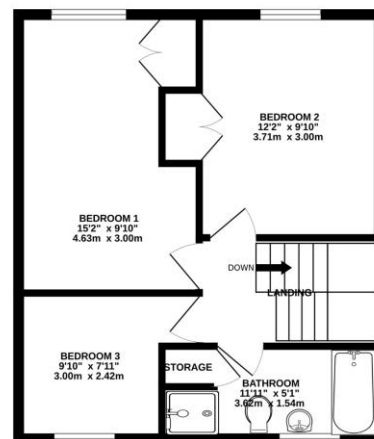

Whilst every attempt has been made to ensure the accuracy of the floorplan contained herein, measurements of doors, windows, rooms and any other items are approximate and no responsibility is taken for any error, omission or mis-statement. This plan is for illustrative purposes only and should be used as such by any prospective purchaser. The services, systems and appliances shown have not been tested and no guarantee as to their operability or efficiency can be given.  
Made with Metropix G3025



**TO ARRANGE A VIEWING PLEASE CONTACT:**  
Tel: **01256 880001** or Email: **info@bridges.co.uk**



**Important Notice - These particulars are set out as a general outline only for the guidance of intended purchasers/tenants and do not form part of any offer or contract and must not be relied upon as statements or representations of fact. Purchasers/Tenants must satisfy themselves by inspection or otherwise as to their correctness.**