



Three Bedroom Terraced House

The Grove, Frimley, Camberley, Surrey, GU16 8PL

Price: £365,000

- Three Bedrooms
- Terraced House
- Separate Kitchen
- Driveway and Garage to the Rear
- Private Garden
- Walking Distance to Hospital and Excellent Schools
- Close to Amenities
- EPC: C (69)



Description

This well presented three-bedroom mid terrace home offers a perfect blend of comfort and practicality, ideal for families, first time buyers or investors - being perfectly located opposite the Frimley Park Hospital and near to excellent schools. Upon entering through the porch, you are welcomed into a spacious open plan living and dining area, an inviting space filled with natural light. To the rear, the kitchen stretches across the back of the property and benefits from ample storage and direct access to the enclosed private garden - offering a great space for outdoor dining and recreation. Upstairs, the property features three well-proportioned bedrooms and a modern family bathroom, providing comfortable living space for growing families.

Outside

Externally, the home boasts a driveway to the front for convenient off-street parking, and a fully enclosed rear garden offering a safe and private outdoor retreat with a sizable shed equipped with lights and power. There is also a garage located around the rear of the property.

To view the Material Information Certificate for this property please click [Here](#) or contact us to request a copy.

Floorplan

GROUND FLOOR

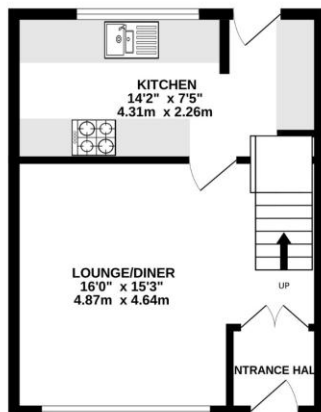
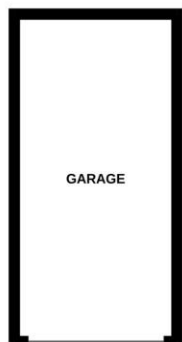

1ST FLOOR

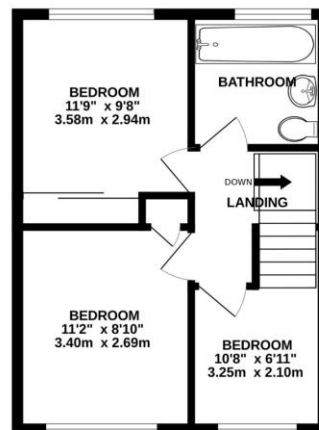

Whilst every attempt has been made to ensure the accuracy of the floorplan contained here, measurements of doors, windows, rooms and any other items are approximate and no responsibility is taken for any error, omission or mis-statement. This plan is for illustrative purposes only and should be used as such by any prospective purchaser. The services, systems and appliances shown have not been tested and no guarantee as to their operability or efficiency can be given.
Made with Metropix ©2025



TO ARRANGE A VIEWING PLEASE CONTACT:
Tel: **01252 361550** or Email: **info@bridges.co.uk**



Important Notice - These particulars are set out as a general outline only for the guidance of intended purchasers/tenants and do not form part of any offer or contract and must not be relied upon as statements or representations of fact. Purchasers/Tenants must satisfy themselves by inspection or otherwise as to their correctness.