



## One Double Bedroom Ground Floor Apartment

### Dempsey Road, Wellesley, Aldershot, Hampshire, GU11 4DN

Price: £240,000

- One Double Bedroom
- Ground Floor Apartment
- Desirable Location
- Well Sized Living Area
- Kitchen with Integrated Appliances
- Allocated Parking
- Estimated Rental Price: £1,100pcm
- EPC: B (82)



## Description

Situated in the heart of Wellesley, this beautifully presented one double bedroom ground floor apartment is offered to the market for the first time since construction. With its convenient position and modern finish, it is an ideal purchase for first-time buyers or local home movers. Upon entering, you are welcomed by a spacious hallway with two built-in storage cupboards. The accommodation comprises a family bathroom, a well-proportioned double bedroom, and a bright open plan living/kitchen area, all enhanced by an abundance of natural light.

## Outside

The property further benefits from an allocated parking space, bin and bicycle storage, and is conveniently positioned close to local walking routes.

To view the Material Information Certificate for this property please click [Here](#) or contact us to request a copy.

## Floorplan

**Dempsey Road, Wellesley, Aldershot, GU11**

Approximate Area = 547 sq ft / 50.8 sq m

For identification only - Not to scale

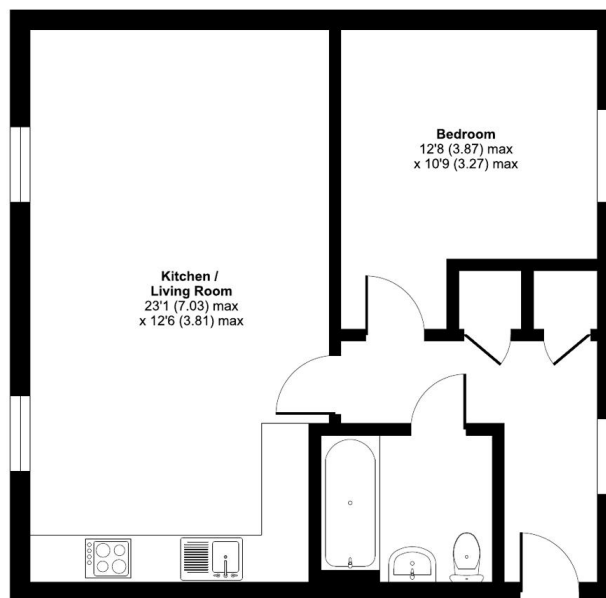

GROUND FLOOR

Floor plan produced in accordance with RICS Property Measurement 2nd Edition, Incorporating International Property Measurement Standards (IPMS2 Residential). © nichiocom 2025. Produced for Bridges Estate Agents. REF: 1345599



**TO ARRANGE A VIEWING PLEASE CONTACT:**  
Tel: **01252 361550** or Email: **info@bridges.co.uk**



Important Notice - These particulars are set out as a general outline only for the guidance of intended purchasers/tenants and do not form part of any offer or contract and must not be relied upon as statements or representations of fact. Purchasers/Tenants must satisfy themselves by inspection or otherwise as to their correctness.