



Two Bedroom End of Terrace House

Highland Road, Aldershot, Hampshire, GU12 4SD

Price: £325,000

- Two Double Bedrooms
- End of Terraced Property
- Downstairs Cloakroom
- Ample Storage Throughout
- Spacious and Airy Hallway
- Family Bathroom
- Ideal for First Time Buyer
- EPC: C (70)



Description

Offered to the market is the fantastic two bedroom end of terraced property. This property is positioned close to local shops, schools and amenities. Downstairs accommodation consists of a sizeable airy hallway, leading on to either the living room, kitchen or downstairs cloakroom. The first floor consists of two great sized double bedrooms with ample storage space, as well as a family bathroom. This home is ideal for local movers or first time buyers alike.

Outside

The rear garden is mainly laid to lawn, with access being granted via side access of from the kitchen. There is also a storage shed as well.

To view the Material Information Certificate for this property please click [Here](#) or contact us to request a copy

Floorplan

GROUND FLOOR

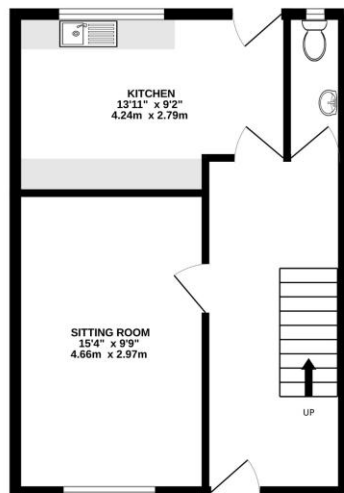

1ST FLOOR

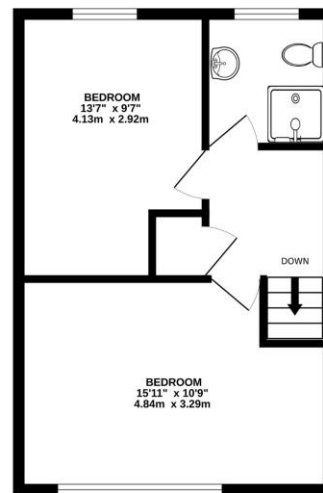

Whilst every attempt has been made to ensure the accuracy of the floorplan contained here, measurements of doors, windows, rooms and any other items are approximate and no responsibility is taken for any error, omission or mis-statement. This plan is for illustrative purposes only and should be used as such by any prospective purchaser. The services, systems and appliances shown have not been tested and no guarantee as to their operability or efficiency can be given.
Made with Metropix ©2025



TO ARRANGE A VIEWING PLEASE CONTACT:
Tel: **01252 361550** or Email: **info@bridges.co.uk**



Important Notice - These particulars are set out as a general outline only for the guidance of intended purchasers/tenants and do not form part of any offer or contract and must not be relied upon as statements or representations of fact. Purchasers/Tenants must satisfy themselves by inspection or otherwise as to their correctness.