



Four Bedroom Detached House

Fern Close, Frimley, Camberley, Surrey, GU16 9QU

Guide Price: £575,000

- Four Bedrooms
- Detached Family Home
- Possibility to Extend/Improve (STPP)
- Garage and Driveway Parking
- Generous East-Facing Rear Garden
- Within Catchment for Excellent Schools
- No Onward Chain
- EPC: E (48)



Description

Bridges are delighted to present this light and spacious four-bedroom detached family home, situated in a sought-after area of Frimley. Ideally positioned within easy reach of local amenities, excellent commuter links, and highly regarded schools, the property offers both convenience and strong future potential. This home is offered to the market with no onward chain and provides an excellent opportunity to extend and enhance (STPP). The ground floor accommodation comprises a welcoming living room, a versatile dining room/family room, a kitchen/breakfast room, and a downstairs cloakroom. To the first floor, there are three generous double bedrooms, a further single bedroom, and a well-proportioned family bathroom. The sellers have thoughtfully provided an illustration of what might be achievable with future extension plans (STPP), highlighting the scope this property has to offer.

Outside

To the front, the property benefits from a garden and driveway providing access to the garage. The rear of the home boasts a generous, east-facing private garden, mainly laid to lawn, offering plenty of outdoor space for relaxation and recreation.

To view the Material Information Certificate for this property please click [Here](#) or contact us to request a copy.

Floorplan

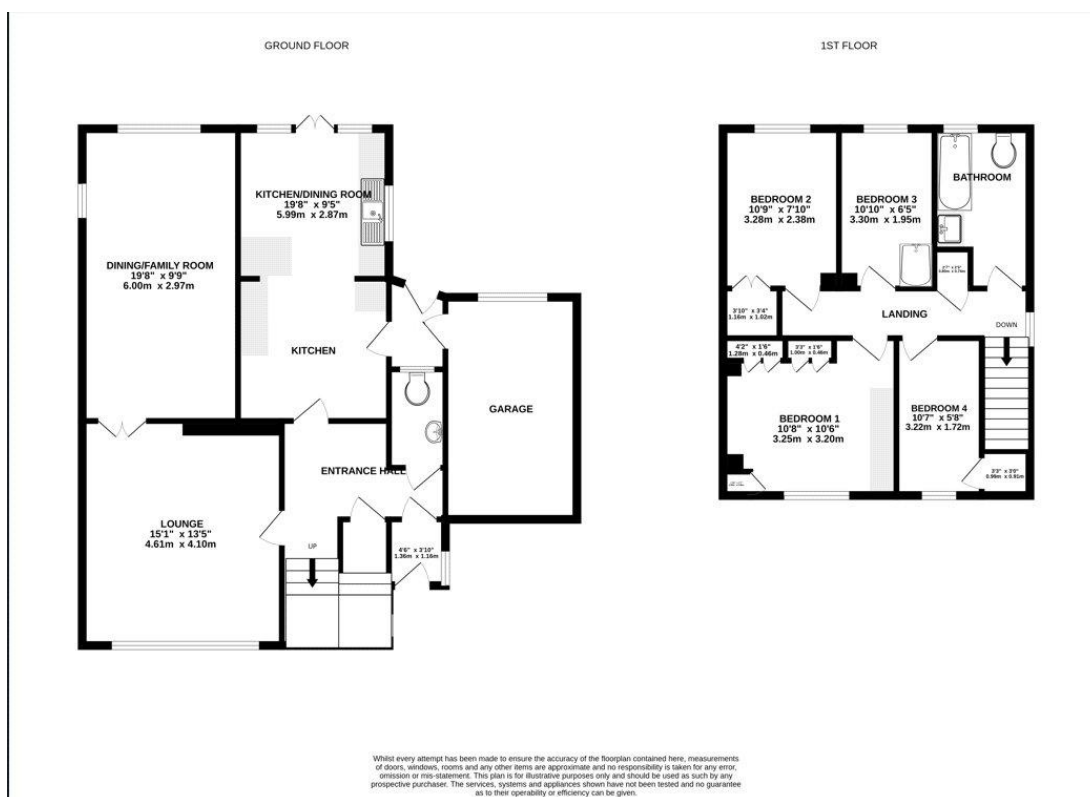

TO ARRANGE A VIEWING PLEASE CONTACT:
Tel: 01252 361550 or Email: info@bridges.co.uk



Important Notice - These particulars are set out as a general outline only for the guidance of intended purchasers/tenants and do not form part of any offer or contract and must not be relied upon as statements or representations of fact. Purchasers/Tenants must satisfy themselves by inspection or otherwise as to their correctness.