



Four Bedroom Detached House

Vetch Field, Hook, Hampshire, RG27 9SL

Price: £800,000

- Four Bedrooms
- Detached Family Home
- Four Reception Rooms
- Three Bathrooms
- Garage
- Driveway Parking
- Utility Room
- EPC: TBC



Description

Situated in a peaceful cul-de-sac within the sought after village of Hook, Vetch Field is a well presented and spacious family home offering a perfect blend of modern living and village charm.

This attractive property boasts generous living accommodation, with four reception rooms on the ground floor, including a bright and airy lounge and separate family room which is ideal for a children's play room or TV room. Additionally, there is another two rooms which the current owners utilise as a home office and gym. These offer flexible living accommodation to suit all families. Finally, on the ground floor there is a contemporary kitchen/dining area, with built-in appliances, and doors out to the garden.

Upstairs there is four double bedrooms, the primary suite stretches the full depth of the property, offering a dressing area and en suite. There is a family bathroom and 'Jack & Jill' style ensuite to bedrooms two and three. All three bathrooms have been recently refurbished.

Located within easy reach of local schools, amenities, and excellent transport links including Hook mainline station and the M3, this is an ideal opportunity for families and professionals alike seeking comfort and convenience in a desirable Hampshire location.

Outside

To the front of the property, there is ample driveway parking for multiple vehicles. The rear garden has been immaculately landscaped and offers both an area of patio and lawn. The garden is an ideal area for families, as well as alfresco dining. There is also a side gate offering access.

To view the Material Information Certificate for this property please click [Here](#) or contact us to request a copy

Floorplan

Vetch Field, Hook, Hampshire, RG27

Approximate Area = 1999 sq ft / 185.7 sq m

Outbuilding = 144 sq ft / 13.3 sq m

Total = 2143 sq ft / 199. sq m

For identification only - Not to scale

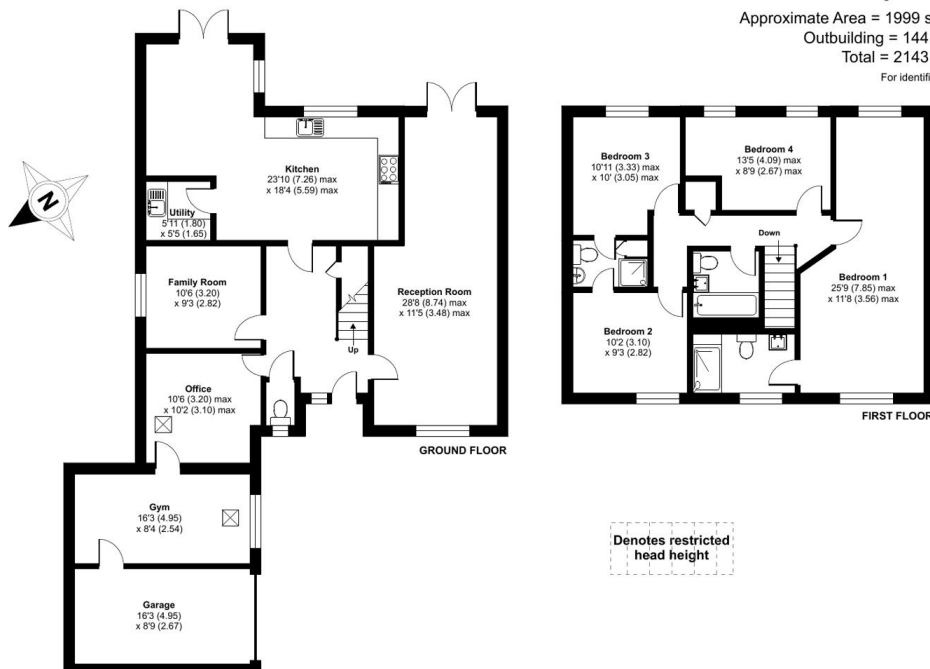

Floor plan produced in accordance with RICS Property Measurement 2nd Edition, incorporating International Property Measurement Standards (IPMS2 Residential). Produced for Bridges Estate Agents. REF: 1330986

Bridges
Estate Agents

Bridges

TO ARRANGE A VIEWING PLEASE CONTACT:
Tel: **01256 769999** or Email: **info@bridges.co.uk**



Important Notice - These particulars are set out as a general outline only for the guidance of intended purchasers/tenants and do not form part of any offer or contract and must not be relied upon as statements or representations of fact. Purchasers/Tenants must satisfy themselves by inspection or otherwise as to their correctness.