



**CRAWLEY RIDGE | CAMBERLEY**

  
**Platinum  
Homes**  
BY BRIDGES





## The Property

Occupying an overall plot of a third of an acre, this substantial detached family home is positioned on one of Camberley's most sought after, tree lined locations and is within walking distance of the town centre.

Boasting over 3,000 square feet, the expansive accommodation boasts three reception rooms, L-shaped kitchen/dining/family area, cloakroom, utility room and airy entrance hallway. Moving upstairs via the hand crafted balustrade, there are four double bedrooms with three bath/shower rooms. The main bedroom is particularly impressive having been extended to offer a dressing area, 20' bedrooms and en suite facilities.

Camberley railway station is within close proximity, as are many popular local schools and amenities. Easy access is provided to both junctions 3 and 4 of the M3 Motorway with Heathrow airport less than half an hour away.



## Outside

Beautifully maintained rear garden offering a high degree of privacy and enjoying much of the afternoon sunshine. Substantial area of patio for outside entertaining, side access to the front. To the front is driveway parking for several vehicles, electric charging point and a double width garage.







## Features

- Four Double Bedrooms
- Three Bath/Shower Rooms
- Kitchen/Dining/Family Area
- Close to Schools
- Over 3,000 Square Feet
- 0.33 Acre Plot
- Double Garage
- Sought after Location



## Contact

**Philip Gascoyne**

[pgascoyne@platinumbybridges.co.uk](mailto:pgascoyne@platinumbybridges.co.uk)

01252 975501

  
**Platinum  
Homes**  
BY BRIDGES



## Fyndon Lea Crawley Ridge, Surrey, GU15

Approximate Area = 2913 sq ft / 270.6 sq m

Garage = 292 sq ft / 27.1 sq m

Total = 3205 sq ft / 297.7 sq m

For identification only - Not to scale

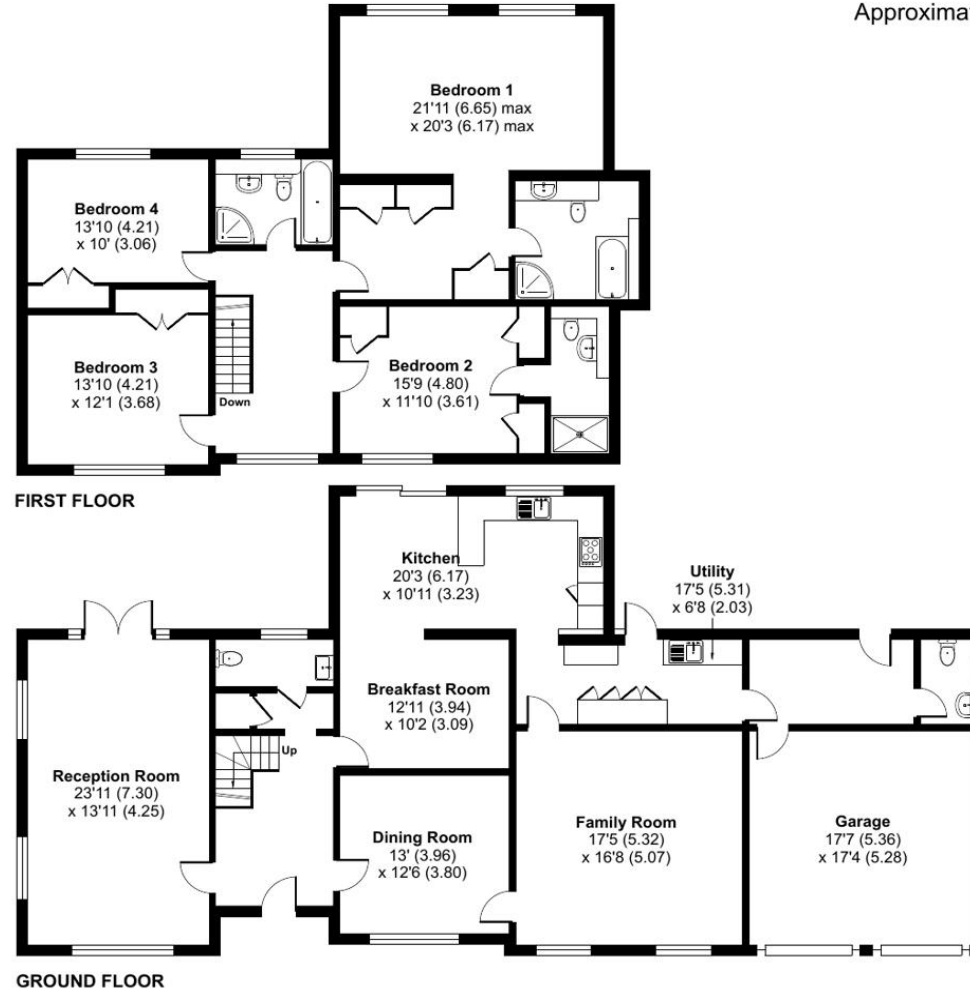

Floor plan produced in accordance with RICS Property Measurement 2nd Edition, incorporating International Property Measurement Standards (IPMS2 Residential). © nitchecom 2025. Produced for Bridges Estate Agents Ltd (Platinum Homes). REF: 1317168



Important Notice - These particulars are set out as a general outline only for the guidance of intended purchasers/tenants and do not form part of any offer or contract and must not be relied upon as statements or representations of fact. Purchasers/Tenants must satisfy themselves by inspection or otherwise as to their correctness.



