



Two Bedroom Apartment

Wordsworth, Bracknell, Bracknell Forest, RG12 8YF

Price: £210,000

- Two Double Bedrooms
- Second Floor Apartment
- 16' Living Room
- Refitted Kitchen
- Allocated Parking
- Ideal First Time Purchase/Investment
- Communal Grounds
- EPC: D (61)



Description

An excellent first time buy/investment to purchase a second floor apartment offering generous accommodation overlooking Yardley play area. Comprising a 16 foot Living Room, two double bedrooms, kitchen and family bathroom. Further benefits include a new roof and double glazed windows and allocated parking.

Outside

The property features communal grounds mainly laid to lawn with allocated parking.

To view the Material Information Certificate for this property please click [Here](#) or contact us to request a copy

Floorplan

TOP FLOOR

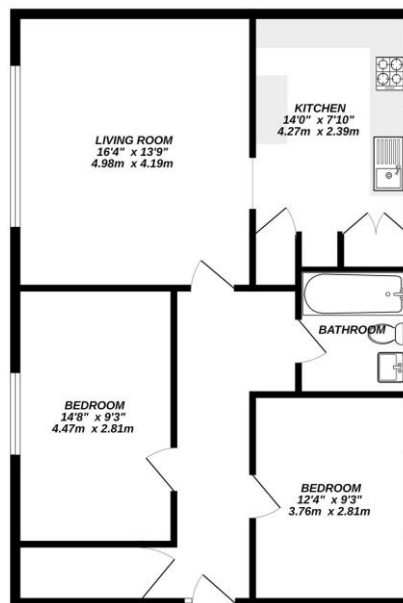

Made with Metropix ©2025



TO ARRANGE A VIEWING PLEASE CONTACT:

Tel: **01344 962150** or Email:



Important Notice - These particulars are set out as a general outline only for the guidance of intended purchasers/tenants and do not form part of any offer or contract and must not be relied upon as statements or representations of fact. Purchasers/Tenants must satisfy themselves by inspection or otherwise as to their correctness.