



CROOKSBURY ROAD | FARNHAM

  
**Platinum  
Homes**  
BY BRIDGES





## The Property

Situated in a peaceful and highly regarded area of Farnham, this spacious five bedroom detached residence occupies a beautifully landscaped one-acre plot. The well-proportioned layout is arranged over two floors, with scope for further extension (subject to planning permission).

The ground floor offers a generous entrance hall, dual aspect sitting room, formal dining room with bay window, kitchen/breakfast room, utility room, cloakroom, family bathroom, and three double bedrooms including a principal suite with bay window, dressing area, and en suite.

The first floor comprises two additional double bedrooms, one with en suite facilities.



## Outside

The grounds have been thoughtfully designed to provide privacy and seasonal interest, with mature trees, established planting, and areas of light woodland.

A spacious driveway provides ample parking and access to two garages, currently used as a gym and home office.

To the rear, a broad terrace adjoins the house, leading to a heated swimming pool with surrounding paved area, a Wendy house, and a hard-court tennis court. A south facing covered pergola offers an additional outdoor entertaining space.







## Features

- Five Bedrooms
- Two Reception Rooms
- Three Further Outbuildings
- Three Bathrooms
- One Acre Plot
- Heated Pool
- Potential to Extend
- EPC: E (53)
- Council Tax Band: B

## Contact

**Philip Gascoyne**

[pgascoyne@platinumbybridges.co.uk](mailto:pgascoyne@platinumbybridges.co.uk)

01252 975501

  
**Platinum  
Homes**  
BY BRIDGES





## Crooksbury Road, Farnham, Surrey, GU10

Approximate Area = 2280 sq ft / 211.8 sq m (excludes stores)

Outbuildings = 347 sq ft / 32.2 sq m

Total = 2627 sq ft / 244 sq m

For identification only - Not to scale

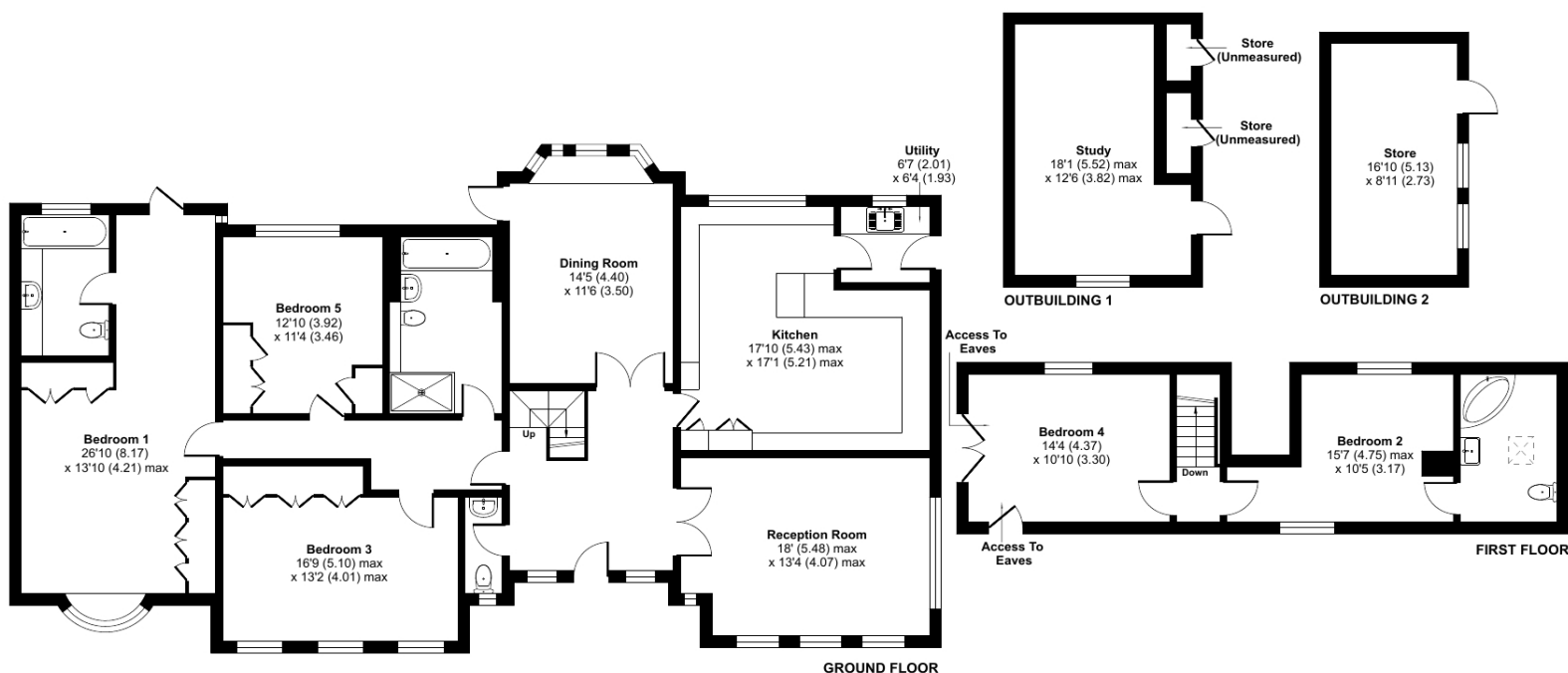

Floor plan produced in accordance with RICS Property Measurement Standards incorporating International Property Measurement Standards (IPMS2 Residential). © nitchcom 2024.  
Produced for Bridges Estate Agents Ltd (Platinum Homes). REF: 1088477

**Platinum  
Homes**  
BY BRIDGES

Important Notice - These particulars are set out as a general outline only for the guidance of intended purchasers and do not form part of any offer or contract and must not be relied upon as statements or representations of fact. Purchasers must satisfy themselves by inspection or otherwise as to their correctness.



