



One Bedroom Ground Floor Apartment Wella Road, Basingstoke, Hampshire, RG22 4FQ

Guide Price: £65,000

- One Double Bedroom
- For Sale by Modern Auction - T&Cs Apply
- Subject to Reservation Price
- Buyers Fees Apply
- Ideal for First Time Buyers or Investment
- No Onward Chain
- Estimated Rental Price: £850 pcm
- EPC: C (69)



Description

Ideally positioned for easy access to a local retail park, town centre and train station is this well presented one double bedroom ground floor apartment. The property is offered with no onward chain, a long lease, allocated parking, modern open plan kitchen/living area and modern fitted bathroom. This property is an ideal investment/first time buy!

Outside

There is a communal entrance and foyer with mailboxes, intercom and a communal seating area. Additionally, there is one allocated parking space.

To view the Material Information Certificate for this property please click [Here](#) or contact us to request a copy

Floorplan

GROUND FLOOR

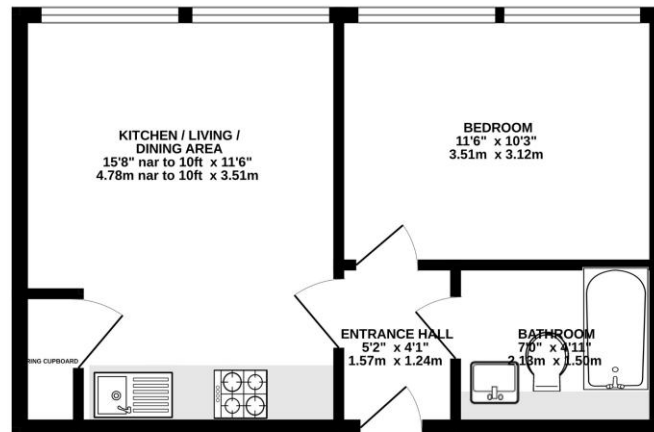

Whilst every attempt has been made to ensure the accuracy of the floorplan contained here, measurements of doors, windows, rooms and any other items are approximate and no responsibility is taken for any error, omission or mis-statement. This plan is for illustrative purposes only and should be used as such by any prospective purchaser. The services, systems and appliances shown have not been tested and no guarantee as to their operability or efficiency can be given.
Made with Metropack 12/2023



TO ARRANGE A VIEWING PLEASE CONTACT:
Tel: **01256 880001** or Email: **info@bridges.co.uk**



Important Notice - These particulars are set out as a general outline only for the guidance of intended purchasers/tenants and do not form part of any offer or contract and must not be relied upon as statements or representations of fact. Purchasers/Tenants must satisfy themselves by inspection or otherwise as to their correctness.