



One Double Bedroom Terraced Apartment

Robin Hood Close, Farnborough, Hampshire, GU14 8TN

Price: £170,000

- One Double Bedroom
- First Floor Apartment
- 88 Years Remaining on Leasehold
- 15ft Living/Dining Room
- Garage Located in a Nearby Block
- Ample Storage Cupboards
- Communal Parking
- EPC: TBC



Description

This well-presented first floor apartment is set within a peaceful, tree-lined cul-de-sac in the popular Prospect development. The property features a 15ft living/dining room, kitchen, 14ft double bedroom, three-piece bathroom suite, and a hallway with three expansive cupboards providing excellent storage. Additional benefits include loft space, communal parking, and a garage located within a nearby block. Enjoying views over the communal grounds with mature trees, the apartment is naturally light throughout the year and benefits from cooling shade in the summer months. Ideally located, the property is within walking distance of local shops, Cove Brook, Moor Road Recreation Grounds and play area, with Farnborough mainline station and town centre only a mile away. This apartment represents a fantastic opportunity for first-time buyers or buy-to-let investors alike.

Outside

The property enjoys views over the communal grounds, with mature trees providing welcome shade in the summer and excellent natural light throughout the winter.

To view the Material Information Certificate for this property please click [Here](#) or contact us to request a copy.

Floorplan

GROUND FLOOR

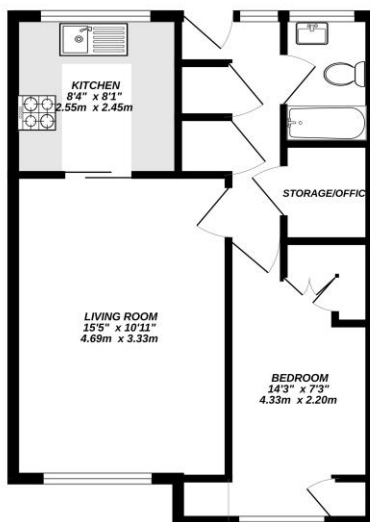

Bridges
Made with Underpage C2025



TO ARRANGE A VIEWING PLEASE CONTACT:
Tel: **01252 361550** or Email: **info@bridges.co.uk**



Important Notice - These particulars are set out as a general outline only for the guidance of intended purchasers/tenants and do not form part of any offer or contract and must not be relied upon as statements or representations of fact. Purchasers/Tenants must satisfy themselves by inspection or otherwise as to their correctness.