

## One Double Bedroom Ground Floor Apartment

**Regents Court, 53 Victoria Road, Aldershot, Hampshire, GU11 1SJ**

**Price: £120,000**

- One Double Bedroom
- Open Plan Living Room/Kitchenette
- Gas Central Heating
- Town Centre Location
- Ideal for First Time Buyers or Investment
- Double Glazed
- Communal Garden
- EPC: D (68)



## Description

A ground floor one-bedroom apartment, ideally located within walking distance of the town centre and mainline station, and offered to the market with no onward chain. Representing an excellent opportunity for first-time buyers or investors alike, the property features an open plan living room with kitchenette, a double bedroom, and a bathroom. There is double glazing throughout. Early viewing is highly recommended with Bridges.

## Outside

The property further benefits from communal garden to the rear, offering a pleasant outdoor space for residents to enjoy. Resident parking is available.

To view the Material Information Certificate for this property please click [Here](#) or contact us to request a copy.

## Floorplan

GROUND FLOOR

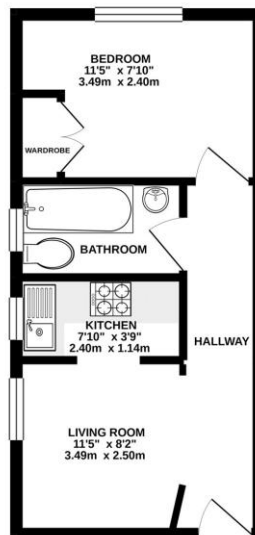

While every attempt has been made to ensure the accuracy of the floorplan contained here, measurements of doors, windows, stairs and any other items are approximate and no responsibility is taken for any error, omission or mis-statement. This plan is for guidance purposes only and should be used as such by any prospective purchaser. The services, fixtures and appliances shown have not been tested and no guarantee as to their operability or efficiency can be given.  
Scale: 1:100 (approx.)



**TO ARRANGE A VIEWING PLEASE CONTACT:**  
Tel: **01252 361550** or Email: **info@bridges.co.uk**



**Important Notice** - These particulars are set out as a general outline only for the guidance of intended purchasers/tenants and do not form part of any offer or contract and must not be relied upon as statements or representations of fact. Purchasers/Tenants must satisfy themselves by inspection or otherwise as to their correctness.