

Studio Apartment

Weydon Lane, Farnham, Surrey, GU9 8UY

Price: £150,000

- Studio Apartment
- Well Maintained
- Parking Available
- Built-in Wardrobes
- Peaceful Development
- Close to Farnham Town and Train Station
- Estimated Rental Price: £900 pcm
- EPC: C (73)



Description

Set within a peaceful development and within walking distance of Farnham town centre and train station, this well-maintained first-floor studio apartment presents an excellent opportunity for first-time buyers or investors. The property features a separate kitchen with partially integrated appliances and a roof window, a modern bathroom, and a bright and spacious main reception room that serves as both the living and bedroom area.

Outside

Externally, the property further benefits from residents' parking, adding to its convenience.

To view the Material Information Certificate for this property please click [Here](#) or contact us to request a copy.

Floorplan

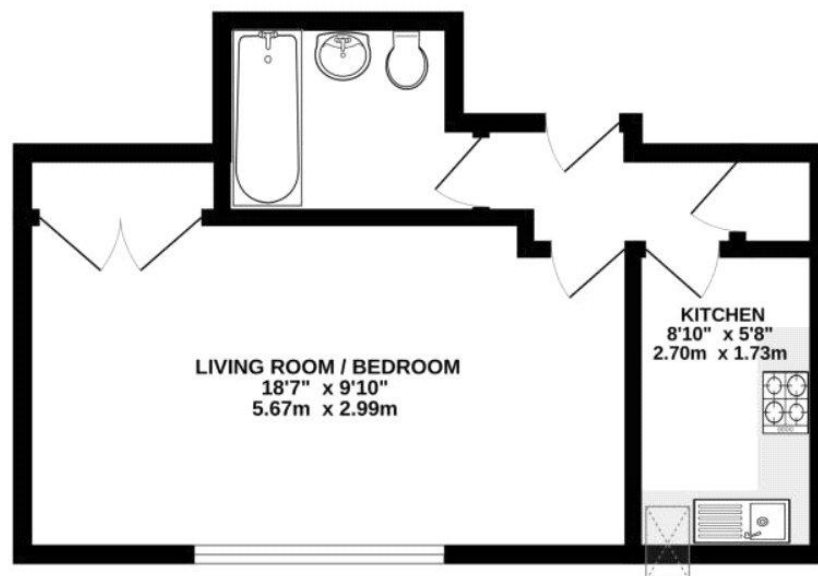

We warrant every effort has been made to ensure the accuracy of the floorplan contained here. Measurements of doors, windows, rooms and any other items are approximate and no responsibility is taken for any error, omission or misstatement. This plan is for illustrative purposes only and should be used as such by any prospective purchaser. The services, systems and appliances shown have not been tested and no guarantee as to their operability or efficiency can be given.
Made with Metagen ©2025



TO ARRANGE A VIEWING PLEASE CONTACT:
Tel: **01252 361550** or Email: **info@bridges.co.uk**



Important Notice - These particulars are set out as a general outline only for the guidance of intended purchasers/tenants and do not form part of any offer or contract and must not be relied upon as statements or representations of fact. Purchasers/Tenants must satisfy themselves by inspection or otherwise as to their correctness.