



## Three Bedroom Detached House

### Willow Way, Farnham, Surrey, GU9 0NU

Price: £500,000

- Three Bedrooms
- Detached Chalet-Style House
- No Onward Chain
- Driveway and Garage
- Desirable Plot
- Close To Popular Schools
- Modern Kitchen/Shower Suite
- EPC: TBC





## Description

Available to the market with no onward chain is this charming three bedroom chalet-style home, ideally positioned in a sought-after location within walking distance of popular schools. Upon entering, you are welcomed by a bright hallway that leads into a spacious lounge with direct access to the rear garden, perfect for entertaining or relaxing with family. The recently fitted kitchen has been finished to a high standard, featuring contemporary units, modern worktops, and integrated appliances. A separate dining room and a versatile third bedroom/study complete the ground floor. Upstairs, the property offers two generously sized double bedrooms with ample storage, accompanied by a beautifully presented, recently fitted shower suite.

## Outside

Externally, the property is set on a manageable plot and enjoys a secluded rear garden, predominantly laid to lawn, offering an ideal space for relaxation or outdoor entertaining. To the front, there is a further lawn area alongside driveway parking for multiple vehicles, which leads up to an attached garage for added convenience.

To view the Material Information Certificate for this property please click [Here](#) or contact us to request a copy.

## Floorplan

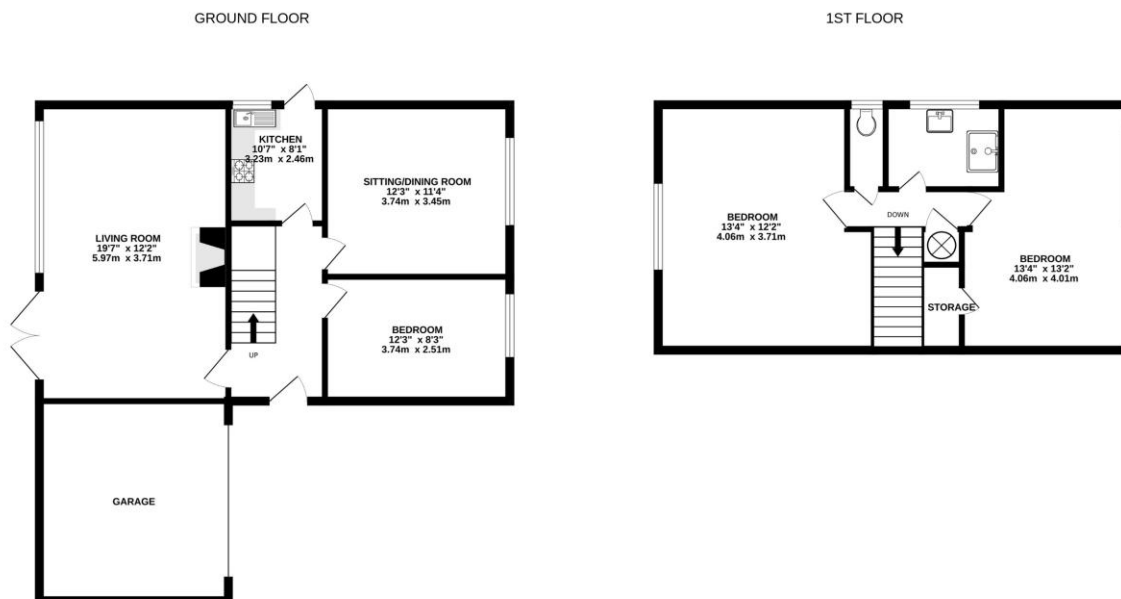

TO ARRANGE A VIEWING PLEASE CONTACT:  
Tel: **01252 361550** or Email: **info@bridges.co.uk**



Important Notice - These particulars are set out as a general outline only for the guidance of intended purchasers/tenants and do not form part of any offer or contract and must not be relied upon as statements or representations of fact. Purchasers/Tenants must satisfy themselves by inspection or otherwise as to their correctness.