



Three Bedroom Semi-Detached House Elston Road, Aldershot, Hampshire, GU12 4HZ

Price: £450,000

- Three Bedrooms
- Semi-Detached Home
- Three Reception Rooms
- Driveway Parking
- Generous Rear Garden
- Well Regarded Residential Road
- Downstairs Cloakroom
- EPC: D (55)



Description

A well-presented semi-detached family home, set in one of Aldershot's most sought-after residential locations. Arranged over two floors and offered in excellent condition throughout, the ground floor comprises three versatile reception rooms and a fitted kitchen, whilst the first floor offers two generous double bedrooms, a further bedroom, and a family bathroom. Externally, the property benefits from a landscaped rear garden, ample parking for multiple vehicles, and a garage. Ideally situated just a mile from the train station, which provides direct services to London Waterloo, the home is also within walking distance of popular schools and the Basingstoke Canal, making it a superb choice for both families and commuters.

Outside

Positioned on a generous plot, the property benefits from a driveway to the front and an attractive rear garden. The garden features a lawn and a patio, perfect for entertaining, and is enclosed by mature hedging and fencing. With established trees, plants and shrubs, it offers a high degree of privacy and seclusion.

To view the Material Information Certificate for this property please click [Here](#) or contact us to request a copy.

Floorplan

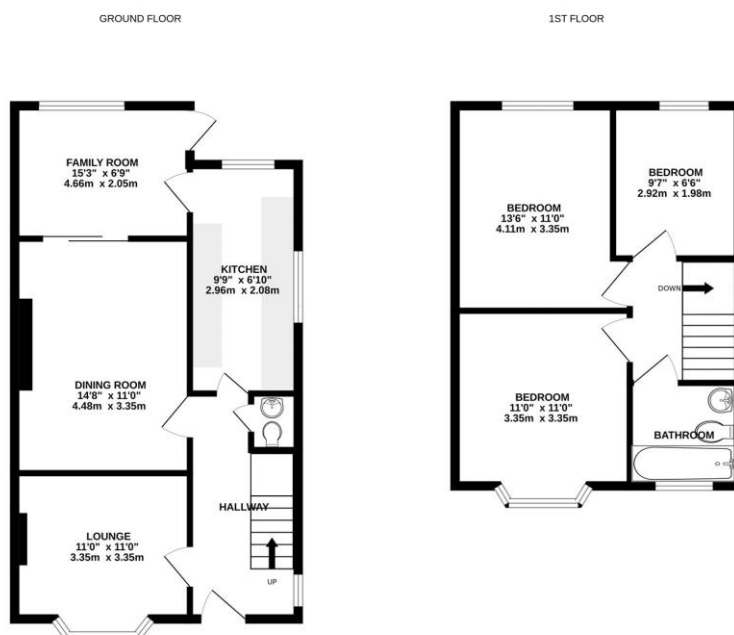

Whilst every attempt has been made to ensure the accuracy of the floorplan contained herein, measurements of doors, windows, rooms and any other items are approximate and no responsibility is taken for any error, omission or mis-statement. This plan is for illustrative purposes only and should be used as such by any prospective purchaser. The services, systems and appliances shown have not been tested and no guarantee as to their operability or efficiency can be given. Made with Metreplan 12/02/20.



TO ARRANGE A VIEWING PLEASE CONTACT:
Tel: **01252 361550** or Email: **info@bridges.co.uk**



Important Notice - These particulars are set out as a general outline only for the guidance of intended purchasers/tenants and do not form part of any offer or contract and must not be relied upon as statements or representations of fact. Purchasers/Tenants must satisfy themselves by inspection or otherwise as to their correctness.