



Three Bedroom Detached Bungalow

Nutbourne, Farnham, Surrey, GU9 9EH

Price: £500,000

- Three Bedrooms
- Link-Detached Bungalow
- Open Plan Kitchen/Living/Dining Space
- Well Presented Bathroom
- South East Facing Garden
- Integral Garage
- 1.4 Miles to Train Station
- EPC : C (73)



Description

A beautifully presented three bedroom link-detached bungalow situated within a peaceful cul-de-sac in the popular Weybourne region of Farnham. The full accommodation comprises three well proportioned double bedrooms, with bedroom one featuring dual aspect allowing for plenty of light and space for both freestanding and integrated wardrobes. Then towards the back is the open plan reception area, which has two skylights and bi-fold doors opening to the rear garden giving fantastic natural light. There is a kitchen area which leads through to a utility space that in turn gives access to an integral garage, while across the rear of the room is the living and dining space.

Outside

To the front of the property there is a generous, paved driveway for multiple vehicles ahead of an integral garage. There is side access through to the rear garden, which is of a south easterly aspect and can also be accessed via bi-fold doors from the open plan living space. The garden is a generous size, with a recently laid patio area from the back of the house, which has sleeper borders. A sociable garden which has been designed for easy maintenance.

Floorplan

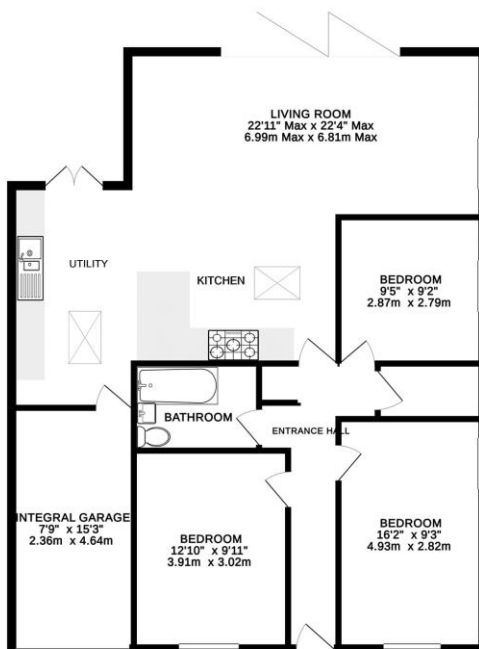

Whilst every attempt has been made to ensure the accuracy of the floorplan contained here, measurements of doors, windows, stairs and any other items are approximate and no responsibility is taken for any error, omission or mis-statement. This plan is for guidance purposes only and should be used as such for any prospective purchaser. The services, systems and appliances shown have not been tested and no guarantee as to their operation or efficiency can be given. Issue date: 10/03/2020

Bridges
co.uk

the hub

To arrange a viewing please contact:

Tel: 01252 361550

Email: info@bridges.co.uk

Important Notice - These particulars are set out as a general outline only for the guidance of intended purchasers and do not form part of any offer or contract and must not be relied upon as statements or representations of fact. Purchasers must satisfy themselves by inspection or otherwise as to their correctness.