



## Three Bedroom Semi-Detached House

**Charlecote Close, Farnborough, Hampshire, GU14 7EG**

Guide Price: £425,000

- Three Bedrooms
- Semi-Detached House
- Two Reception Rooms
- Four-Piece Bathroom Suite
- Low Maintenance Garden
- Driveway Parking
- Highly Sought-After Area
- EPC: C (71)





## Description

Situated in a highly sought-after residential location, this modern and spacious three bedroom semi-detached home offers stylish interiors, versatile living space, and generous off-street parking. The property features three well-proportioned double bedrooms, providing comfortable accommodation for families or professionals alike. On the ground floor, two separate reception rooms create flexible spaces for both relaxation and entertaining, while the contemporary kitchen is fitted to a high standard. The family bathroom is equally impressive, boasting a sleek four-piece suite complete with both a bath and separate shower. Externally, the home continues to shine with a low-maintenance rear garden—perfect for outdoor dining and leisure, and a substantial driveway to the front, offering parking for multiple vehicles. Early viewing is strongly recommended to appreciate all that this fantastic home has to offer.

## Outside

Externally, the property benefits from driveway parking for multiple vehicles. To the rear, the garden has been designed for ease of maintenance, featuring a combination of artificial lawn and a spacious patio area—perfect for outdoor dining and entertaining.

## Floorplan

GROUND FLOOR

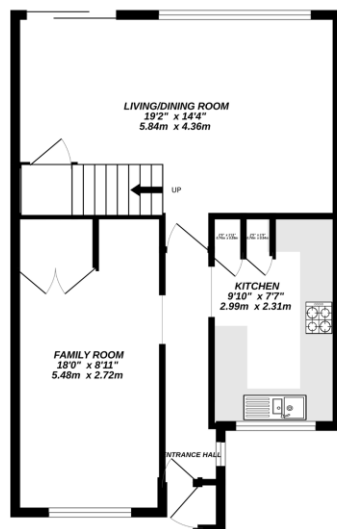

1ST FLOOR

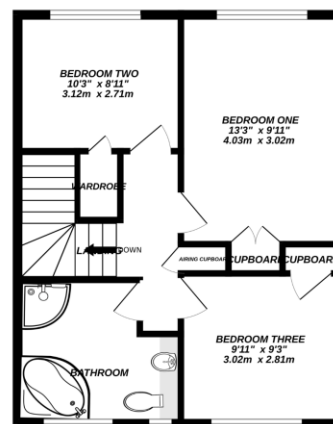

Bridges  
Made with Metropix ©2025



**TO ARRANGE A VIEWING PLEASE CONTACT:**  
Tel: **01252 361550** or Email: **info@bridges.co.uk**



**Important Notice -** These particulars are set out as a general outline only for the guidance of intended purchasers/tenants and do not form part of any offer or contract and must not be relied upon as statements or representations of fact. Purchasers/Tenants must satisfy themselves by inspection or otherwise as to their correctness.