

One Bedroom Maisonette

Murrell Road, Ash, Surrey, GU12 6ST

Price: £170,000

- One Double Bedroom
- Ground Floor Maisonette
- No Chain
- Low Monthly Charges
- Good Condition Throughout
- Easy Walking Distance to Train Station
- Quiet Location
- EPC: C (76)



Description

Located at the end of a quiet cul-de-sac is this one double bedroom ground floor maisonette, offered to the market with no onward chain. The property features a spacious living area, gas central heating, and resident parking. Local amenities, train stations, parks, and major road links are all easily accessible, making this an ideal first time or investment purchase. Upon entering, you are welcomed by an entrance hall with doors to all rooms and two useful storage cupboards. The main living area is light and well proportioned, while the kitchen is fitted with a range of eye and base level units, generous work surface space, and room for a cooker, fridge/freezer, and washing machine. The bedroom is very spacious, and the bathroom has been recently refitted to a modern standard.

Outside

Outside, the property enjoys communal gardens, a peaceful outlook, and easy access to Ash train station and village amenities.

To view the Material Information Certificate for this property please click [Here](#) or contact us to request a copy.

Floorplan

GROUND FLOOR

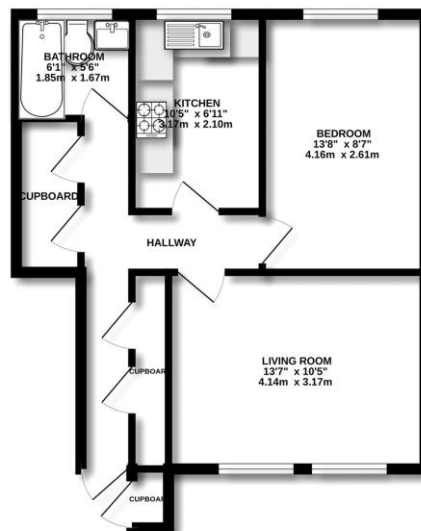

Measurements are approximate. Not to scale. Illustrative purposes only. Made with Smartplan (2020)



TO ARRANGE A VIEWING PLEASE CONTACT:
Tel: **01252 361550** or Email: **info@bridges.co.uk**



Important Notice - These particulars are set out as a general outline only for the guidance of intended purchasers/tenants and do not form part of any offer or contract and must not be relied upon as statements or representations of fact. Purchasers/Tenants must satisfy themselves by inspection or otherwise as to their correctness.