



## Two Bedroom Apartment

**Church Road West, Farnborough, Hampshire, GU14 6QG**

Offers in Excess of: £195,000

- Two Bedrooms
- Top Floor Apartment
- Separate Kitchen
- Juliette Balcony
- Close to Local Amenities
- Ideal Investment/First Time Buy
- Estimated Rental Price: £1,100 pcm
- EPC: C (73)



## Description

This bright and airy two bedroom top floor apartment is located in the popular North Camp area close to King George V park and offers modern, comfortable living throughout. The spacious open plan living area features a charming Juliet balcony that fills the space with natural light. Residents can park anywhere and there are ample spaces for residents with multiple cars.

## Outside

The surrounding area offers easy access to North Camp's local amenities, transport links, and green spaces, making it a highly practical and well situated home.

## Floorplan

TOP FLOOR

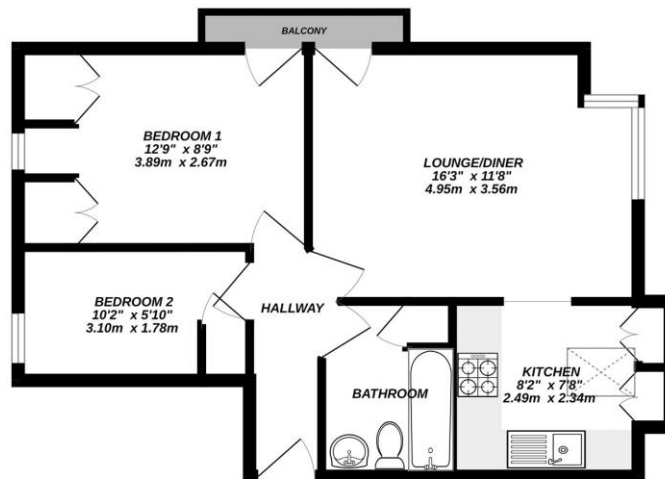

Bridges  
Made with Metropix 12025



**TO ARRANGE A VIEWING PLEASE CONTACT:**  
Tel: **01252 361550** or Email: **info@bridges.co.uk**



Important Notice - These particulars are set out as a general outline only for the guidance of intended purchasers/tenants and do not form part of any offer or contract and must not be relied upon as statements or representations of fact. Purchasers/Tenants must satisfy themselves by inspection or otherwise as to their correctness.