



Four Bedroom Detached House

Cambrian Close, Camberley, Surrey, GU15 3LD

Guide Price: £650,000

- Four Bedrooms
- Detached Family Home
- En Suite and Family Bathroom
- Spacious Living Room
- Garage
- Cul-de-Sac Location
- Close to Camberley Town Centre
- EPC: C (74)



Description

Offered to the market is this four-bedroom family home, situated in a sought-after location. The ground floor comprises a kitchen and dining room, alongside a spacious living room to the rear, with access to the garden and utility room. Upstairs are four well-proportioned bedrooms, with three of them benefitting from built-in wardrobes. You will also find a family bathroom, and an en suite to the main bedroom. The property still offers buyers further potential to extend and improve, subject to planning. Give us a call today to book your viewing!

Outside

To the front there is parking for multiple vehicles and access to the garage. The rear garden benefits from a spacious patio area with the rest mainly laid to lawn, ideal for family BBQs!

To view the Material Information Certificate for this property please click [Here](#) or contact us to request a copy.

Floorplan

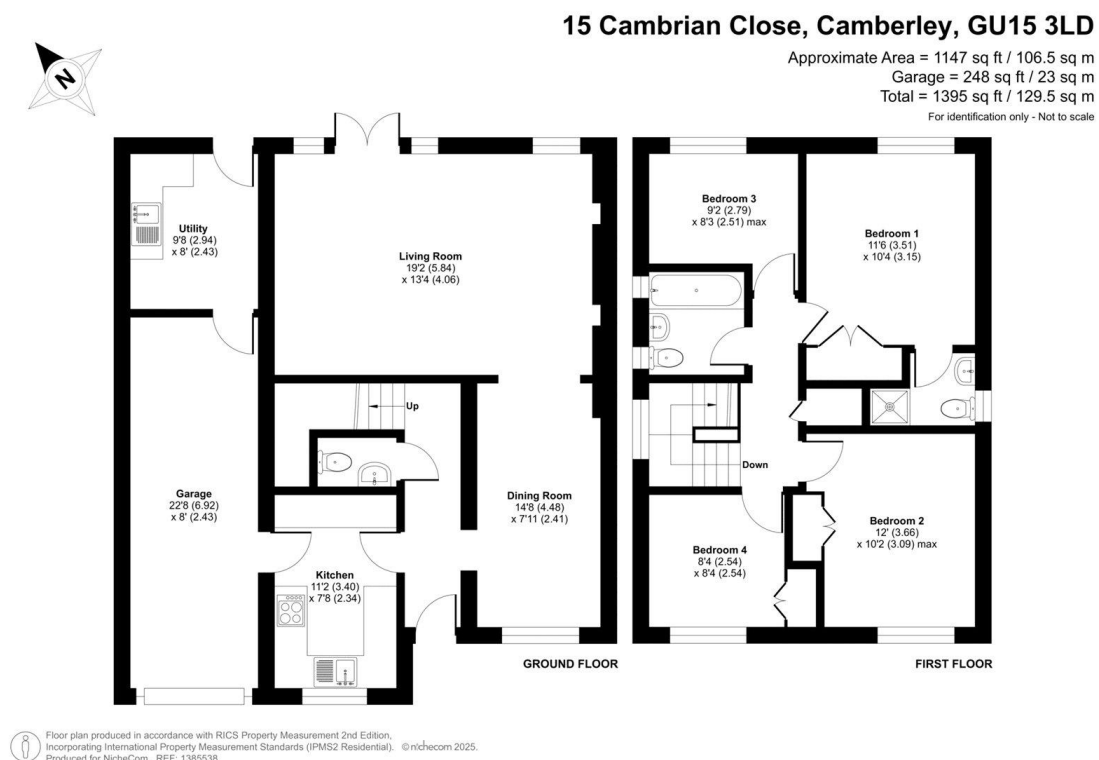

TO ARRANGE A VIEWING PLEASE CONTACT:

Tel: 01276 685544 or Email:

camberley@bridges.co.uk



Important Notice - These particulars are set out as a general outline only for the guidance of intended purchasers/tenants and do not form part of any offer or contract and must not be relied upon as statements or representations of fact. Purchasers/Tenants must satisfy themselves by inspection or otherwise as to their correctness.