



Three Bedroom Detached Bungalow

Coach House Close, Frimley, Camberley, Surrey, GU16 8TR

Price: £525,000

- Three Bedrooms
- Expansive Living and Dining Rooms
- 11ft Fitted Kitchen
- Modern Fitted Bathroom
- Driveway and a Garage
- Scope for Improvement (STPP)
- Easy Access to Frimley Park Hospital
- EPC: D (64)



Description

Tucked away in a cul-de-sac, and with easy access to Frimley Park Hospital, local schools, shops, and Frimley high street, is this spacious three-bedroom detached bungalow on a generous and private plot. Accommodation includes a 15ft living room with an electric fireplace, 12ft dining area with original Parquet flooring throughout, 11ft kitchen, modern fitted bathroom with a walk-in shower, three well-proportioned bedrooms including a 12ft main bedroom with built-in wardrobes, and a substantial insulated loft space with a built-in discrete folding loft ladder to access. There is great scope for improvement (STPP), and no onward chain complications with probate already granted.

Outside

Outside there is driveway parking for multiple vehicles and a single garage with power, with room to extend or replace the garage with a double garage. The plot extends to approximately 0.19 acres and boasts direct access to Warren Wood via a private gate to the rear of the property. The rear garden benefits from a generous area of patio, a shed, and there is a lean-to greenhouse to the rear of the garage. The property sits at the most elevated point of the Close giving far reaching views of Tekels Park and Warren Woods. Further benefits include easy access to Frimley Park Hospital, local schools, and great travel links.

To view the Material Information Certificate for this property please click [Here](#) or contact us to request a copy.

Floorplan

GROUND FLOOR

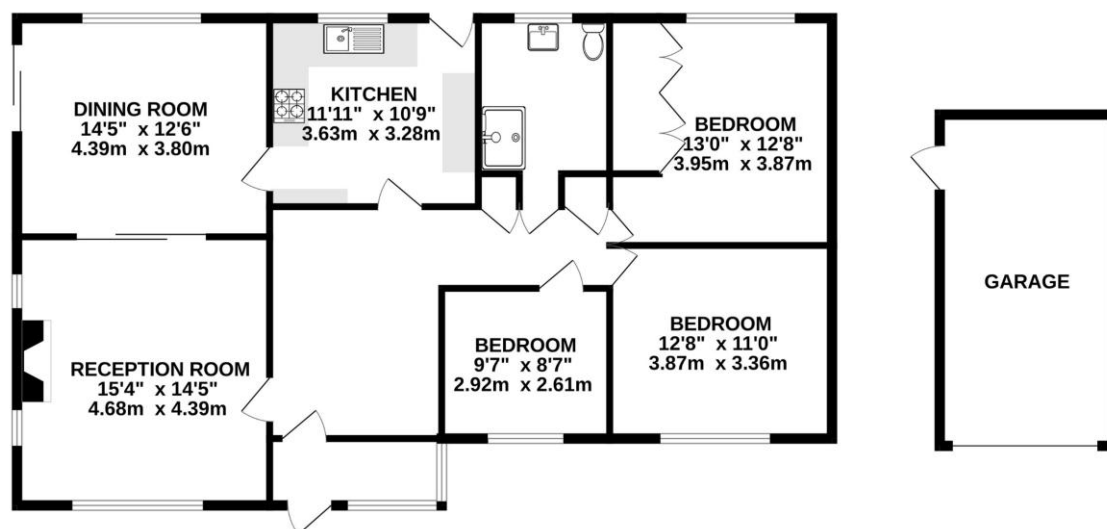

Whilst every attempt has been made to ensure the accuracy of the floorplan contained here, measurements of doors, windows, rooms and any other items are approximate and no responsibility is taken for any error, omission or mis-statement. This plan is for illustrative purposes only and should be used as such by any prospective purchaser. The services, systems and appliances shown have not been tested and no guarantee as to their operability or efficiency can be given.
Made with Metropix ©2025



TO ARRANGE A VIEWING PLEASE CONTACT:
Tel: **01252 361550** or Email: **info@bridges.co.uk**



Important Notice - These particulars are set out as a general outline only for the guidance of intended purchasers/tenants and do not form part of any offer or contract and must not be relied upon as statements or representations of fact. Purchasers/Tenants must satisfy themselves by inspection or otherwise as to their correctness.