



Three Bedroom End of Terrace House

Yalden Gardens, Tongham, Surrey, GU10 1FJ

Offers in Excess of: £450,000

- Three Bedrooms
- Immaculate Condition Throughout
- Close to Popular Schools and Transport Links
- New Build Warranty in Place
- Modern En Suite, Bathroom and Downstairs Cloakroom
- Integrated Appliances
- Driveway Parking
- EPC: B (83)



Description

Offered to the market in immaculate condition is this three bedroom end of terrace home, built in 2018. It is set in a sought after, quiet location close to popular schools, transport links, and lovely walking spots. The property has been beautifully maintained by the current owners and benefits from driveway parking for two vehicles, plus side access to the private rear garden.

Downstairs features a modern kitchen/breakfast room with high spec units, quality worktops, integrated appliances, and a bay fronted dining area. There is also a front cloakroom, and the spacious rear living room opens onto the low maintenance garden.

Upstairs offers three well proportioned bedrooms and a family bathroom. The main bedroom includes built-in wardrobes and an en suite shower room.

Located within walking distance of Ash train station and offering easy access to the A31 and A331 for Guildford or Farnham, this home truly must be seen to be appreciated. Contact us today to arrange your viewing.

Outside

To the front, there is driveway parking for two vehicles, with side access to the rear garden on the right hand side. The rear garden features an extended patio and is fully enclosed with smart wood fencing.

To view the Material Information Certificate for this property please click [Here](#) or contact us to request a copy.

Floorplan

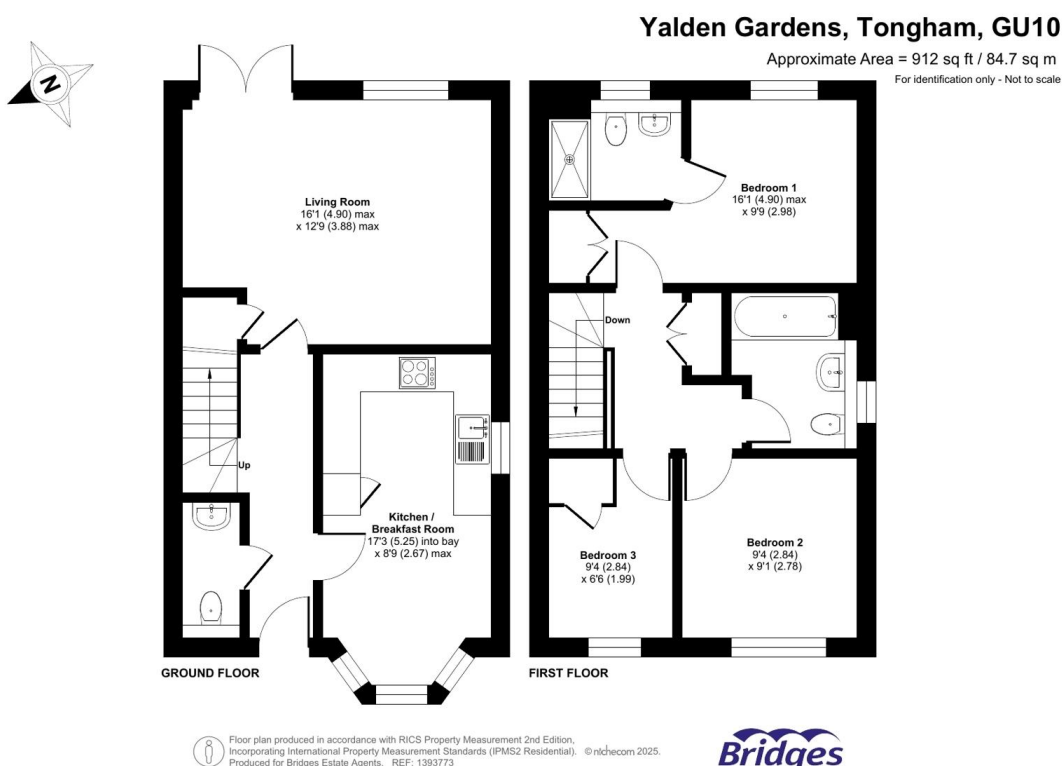

TO ARRANGE A VIEWING PLEASE CONTACT:
Tel: **01252 361550** or Email: **info@bridges.co.uk**



Important Notice - These particulars are set out as a general outline only for the guidance of intended purchasers/tenants and do not form part of any offer or contract and must not be relied upon as statements or representations of fact. Purchasers/Tenants must satisfy themselves by inspection or otherwise as to their correctness.