



## One Bedroom Apartment

**Tasmania Close, Basingstoke, Hampshire, RG24 9PQ**

£1,100 per month

- One Double Bedroom Apartment
- Living/Dining Room
- Kitchen
- Bathroom
- Communal Grounds and Parking
- Ideal for Professionals
- Desirable Area
- EPC: E (46)





## Description

Available Early April (Unfurnished) - This one double bedroom apartment is ideal for professionals and is situated within a desirable area. The accommodation includes: living/dining room, kitchen, plus bathroom.

## Outside

Outside there are communal grounds and parking.

## Floorplan

GROUND FLOOR

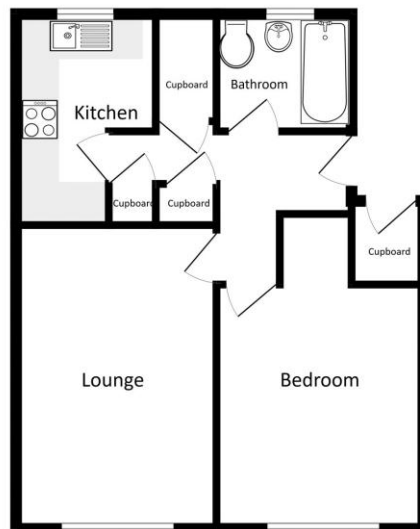

While every attempt has been made to ensure the accuracy of the floorplan contained herein, measurements of doors, windows, rooms and any other items are approximate and no responsibility is taken for any error, omission or mis-statement. This plan is for illustrative purposes only and should be used as a guide only for prospective purchasers. The services, fixtures and appliances shown here may not be present and no guarantee as to their operability or efficiency can be given. Make well mortgage 02020



TO ARRANGE A VIEWING PLEASE CONTACT:  
Tel: **01256 880011** or Email: **lettings@bridges.co.uk**



Important Notice - These particulars are set out as a general outline only for the guidance of intended purchasers/tenants and do not form part of any offer or contract and must not be relied upon as statements or representations of fact. Purchasers/Tenants must satisfy themselves by inspection or otherwise as to their correctness.