



## Three Bedroom Semi-Detached House

**Bruntile Close, Farnborough, Hampshire, GU14 6PR**

£1,900 per month

- Three Bedroom Semi-Detached House
- Living/Dining Room
- Kitchen with Appliances
- Bathroom
- Private Garden and Parking
- Good Decorative Order
- Popular Area
- EPC: D (67)





## Description

Available Mid February (Unfurnished) - This three-bedroom semi-detached house is presented in good decorative order and is situated in a popular area. The accommodation includes: living/dining room, kitchen with appliances, plus bathroom.

## Outside

Outside there is a private garden and parking.

To view the Material Information Certificate for this property please click [Here](#) or contact us to request a copy.

## Floorplan

GROUND FLOOR



1ST FLOOR

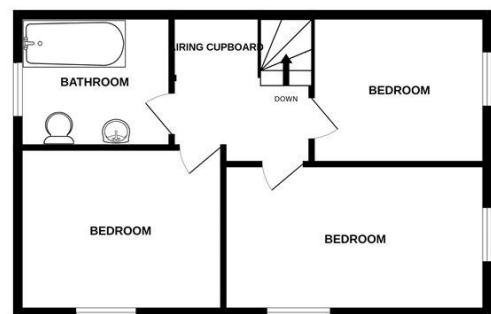

Whilst every attempt has been made to ensure the accuracy of the floorplan contained here, measurements of doors, windows, rooms and any other items are approximate and no responsibility is taken for any error, omission or mis-statement. This plan is for illustrative purposes only and should be used as such by any prospective purchaser. The services, systems and appliances shown have not been tested and no guarantee as to their operability or efficiency can be given.  
Made with Metropix ©2025



**TO ARRANGE A VIEWING PLEASE CONTACT:**  
Tel: **01252 359887** or Email: **lettings@bridges.co.uk**



**Important Notice** - These particulars are set out as a general outline only for the guidance of intended purchasers/tenants and do not form part of any offer or contract and must not be relied upon as statements or representations of fact. Purchasers/Tenants must satisfy themselves by inspection or otherwise as to their correctness.