



## Two Bedroom Apartment

**Alencon Link, Basingstoke, Hampshire, RG21 7TS**

**£1,350 per month**

- Two Bedroom Apartment
- Living/Dining Room
- Kitchen with Appliances
- Bathroom and En Suite
- Allocated Parking
- Modern Wifi Controlled Heating
- Close to the Train Station
- EPC: C (78)



## Description

Available Late January (Unfurnished) - This two bedroom apartment is ideal for professionals and is close to the train station with links to London Waterloo. The accommodation includes: living/dining room, kitchen with appliances, plus bathroom and en suite.

## Outside

Outside there is allocated parking.

To speed up the reservation process, we recommend you attend all viewings with your original right to rent documents; photo ID (passport) plus a proof of address (e.g. drivers license/utility bill/bank statement dated within the last three months). SECURITY DEPOSIT: £1,557.60.

## Floorplan

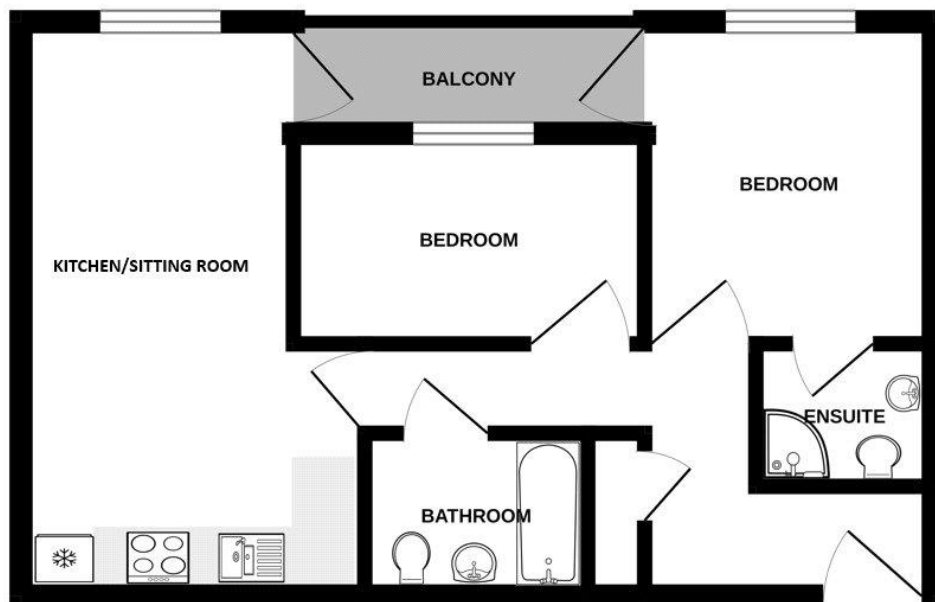

Whilst every attempt has been made to ensure the accuracy of the floorplan contained here, measurements of doors, windows, rooms and any other items are approximate and no responsibility is taken for any error, omission or mis-statement. This plan is for illustrative purposes only and should be used as such by any prospective purchaser. The services, systems and appliances shown have not been tested and no guarantee as to their operability or efficiency can be given.  
Made with Metropix ©2024



**TO ARRANGE A VIEWING PLEASE CONTACT:**

**Tel: 01256 880011 or Email: [lettings@bridges.co.uk](mailto:lettings@bridges.co.uk)**



**Important Notice - These particulars are set out as a general outline only for the guidance of intended purchasers/tenants and do not form part of any offer or contract and must not be relied upon as statements or representations of fact. Purchasers/Tenants must satisfy themselves by inspection or otherwise as to their correctness.**